

EURO★ONE

www.zaferenergy.com

SLI BATTERY

☑ Starting ☑ Lighting ☑ Ignition



ZAFER ENERGY SYSTEMS IND. & FOREIGN TRADE CO. LTD



CONTENTS

Technology Advantage of Zafer Energy Automotive Battery	01
Product Structure	02
Terminal	03
Hold Down	03
Lay-out	04
Handles	04
JIS Type Specification	05
DIN Type Specification	07
BCI Type Specification	09
JSE Type Specification	12
Product Structure	13
Typical Applications	14
User Guide	15



Assembly Line

Completely Model Matching

All batteries using incar can find matching model in ZAFER ENERGY automotive battery series. ZAFER ENERGY can fulfill any need of user. Tailor made product is available for customer with special requirement in short time.

Ultra long life time

Can be charged, discharged and startup for over 5000 times comparatively longer life time than normal battery .

Excellent performance

Mighty power and startup ability, unique design and workmanship ensure ZAFER ENERGY automotive battery's performance on high-rate discharging. Vehicle can be startup easily by ZAFER ENERGY automotive battery even under a extreme temperature of -30 ℃.

High capacity: Capacity design according to most of the international standard, ensure adequacy power supply.

Maintenance free battery using high purity lead calcium alloy, special circulation and structure sealing design lead to infinitesimal water volatilization and longer life time.

Battery using special high purity leads antimony alloy , low water volatilization and excellent startup performance.

Ultra storability; ZAFER ENERGY maintenance free battery have very low self-discharge rate, only 3-5% per month in average. Battery can startup the vehicle easily even after one year storing.

Good anti-vibration performance, fully consider effect of vehicle vibration when design. ZAFER ENERGY can ensure not be damaged by vibration and shock under a poor road condition.

TECHNOLOGY ADVANTAGE OF ZAFER ENERGY AUTOMOTIVE BATTERY

Safe and environmental friendly

User safety is always our first priority. Batteries are environmental friendly during the whole life time.

Humanity product design

Considering for user's convenience with good looking appearance.

Strong technology and developing power

ZAFER ENERGY have excellent technology and development team, international standard laboratory We can speed up design and develop new product under APQP program for our client. It's ensuring the excellent performance of ZAFER ENERGY battery

Strict Quality control

ZAFER ENERGY have ISO/TS16949 certification. Our professional management team working for zero inferior and ensures the reliability of ZAFER ENERGY battery.

Perfect customer service system

We highly regarding all feedback from customer , our customer service department will support you in shortest time and provide you a satisfactory solution.



Strip casting production line



PRODUCT STRUCTURE

High Performance Maintenance Free Series Battery

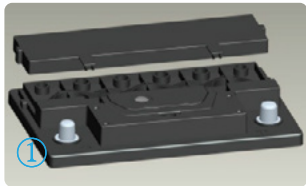

Battery lid

Unique acid circumfluence and air exhaust design minimize the water volatilization, prolong battery life time



Charge condition indicator

Build in indicator, display the charge status

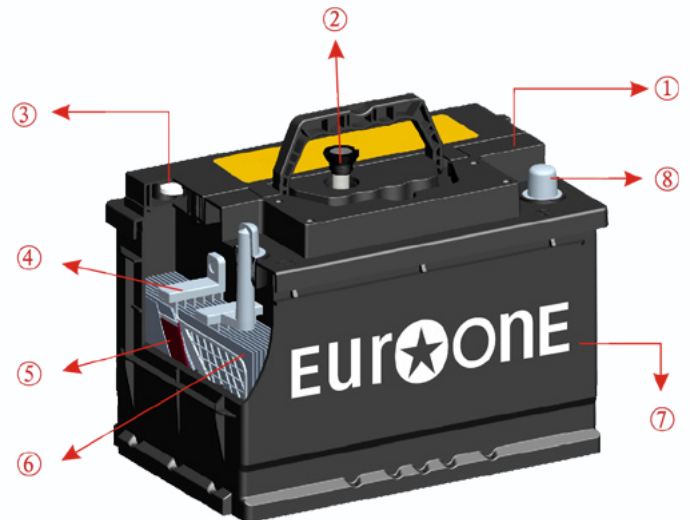
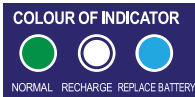

Anti-acid and explosion slice

Filtering acidic mist, prevent acid flow out, protect the environment, prevent flame get in, safety and reliable



PE bag Separator

Imported PE bag shape separator, high micro pore rate and small aperture, low internal resistance, good for high rate discharging

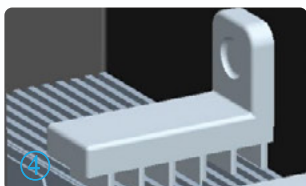

Strap and Lead part for welding

Parts are cast and weld with high conductivity lead alloy, using TTP welding technology, excellent performance on high rate startup.

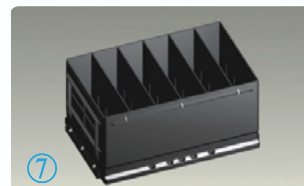

Cell slot

Polypropylene injection molding, high intensity, smooth and clear surface. Anti shock and vibration structure design.

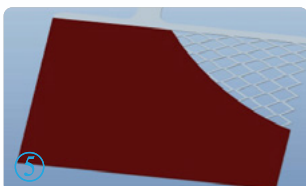

Plate

Emanate from, central lug, lead calcium alloy plate, minimized water volatilization. Special lead lump formula, excellent performance on high rate discharge and charge acceptance

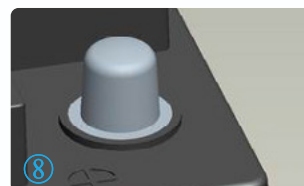

Terminal

Made by high intensity lead alloy, anti mechanical damage, good conductivity, suitable for high rate discharging

↘ **TERMINAL**

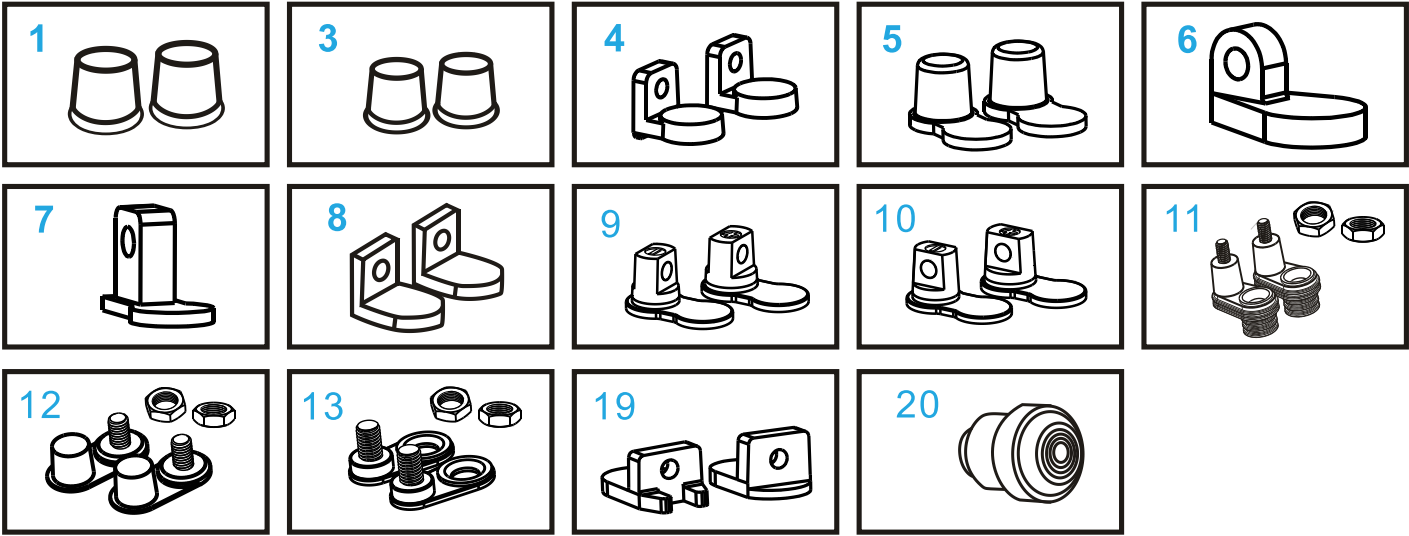

↘ **HOLD DOWN**

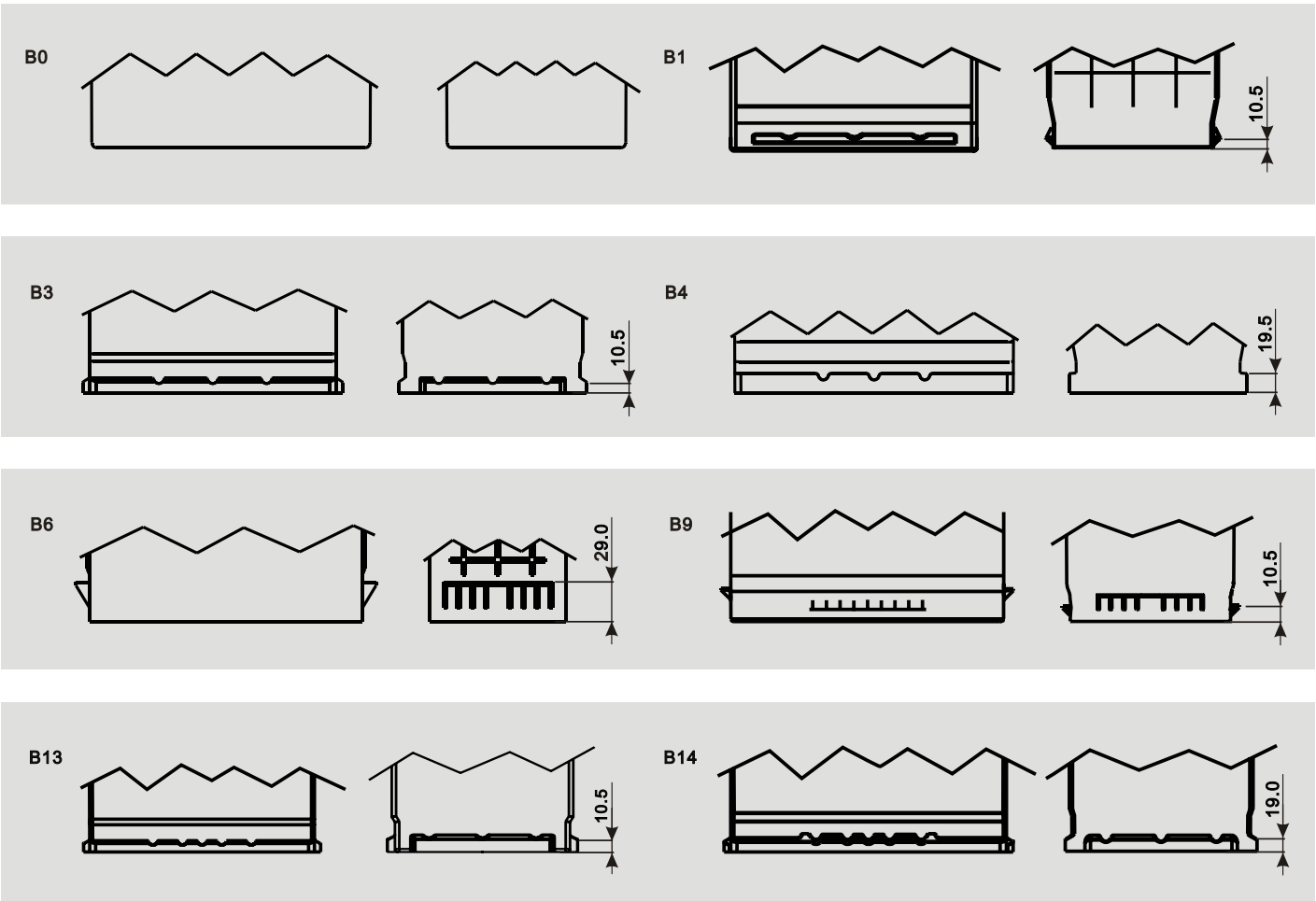



↘ LAY-OUT

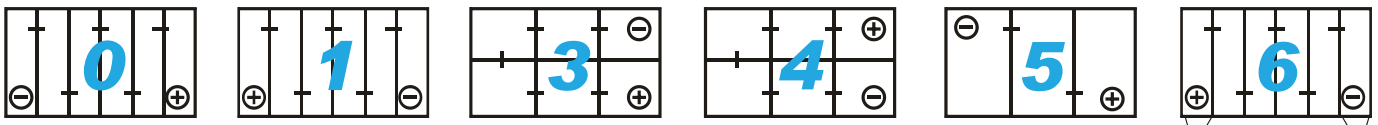

↘ Handles

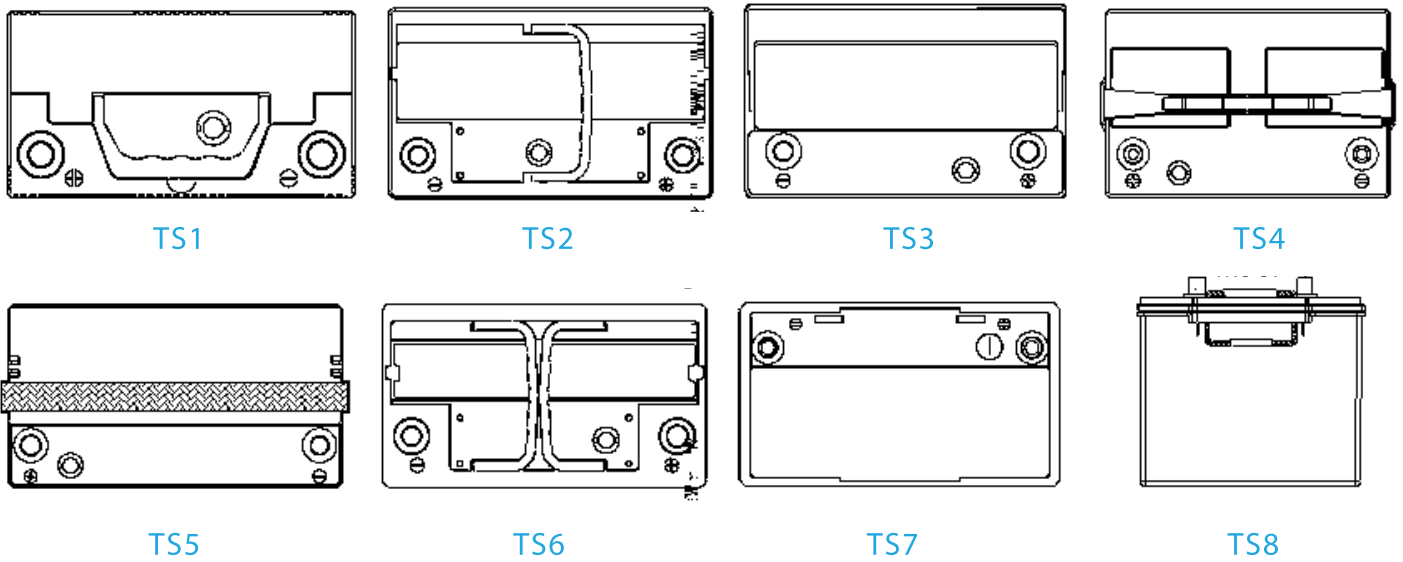

JIS

TYPE

(CALCIUM-CALCIUM)

MAINTENANCE FREE BATTERY



SPECIFICATION

Group Number	JIS old Type	JIS new Type	Nominal Voltage (V)	C ₂₀ Capacity (Ah)	C ₅ Capacity (Ah)	RC (min)	CCA (SAE)	Maximum Overall dimension(mm)				Cell Layout	Terminal	Hold Down	Handles
								L	W	H	TH				
B20	NS40 ENL	36B20L	12	35	28	47	310	195	126	201	221	0	3	B0	TS1
	NS40 EN	36B20R	12	35	28	47	310	195	126	201	221	1	3	B0	TS1
	NS40L(S)	36B20LS	12	35	28	47	310	195	126	201	221	0	1	B0	TS1
	NS40(S)	36B20RS	12	35	28	47	310	195	126	201	221	1	1	B0	TS1
	NS40ZL	38B20L	12	36	28	54	335	195	126	201	221	0	3	B0	TS1
	NS40Z	38B20R	12	36	28	54	335	195	126	201	221	1	3	B0	TS1
	NS40ZL(S)	38B20LS	12	36	28	54	335	195	126	201	221	0	1	B0	TS1
	NS40Z(S)	38B20RS	12	36	28	54	335	195	126	201	221	1	1	B0	TS1
B24	N40L	32B24L	12	40	32	61	350	237	128	200	222	0	3	B0	TS1
	N40	32B24R	12	40	32	61	350	237	128	200	222	1	3	B0	TS1
	N40L(S)	32B24LS	12	40	32	61	400	237	128	200	222	0	1	B0	TS1
	N40(S)	32B24RS	12	40	32	61	400	237	128	200	222	1	1	B0	TS1
	NS60L	46B24L	12	45	36	70	350	237	128	200	222	0	3	B0	TS1
	NS60	46B24R	12	45	36	70	350	237	128	200	222	1	3	B0	TS1
	NS60L(S)	46B24LS	12	45	36	70	450	237	128	200	222	0	1	B0	TS1
	NS60(S)	46B24RS	12	45	36	70	450	237	128	200	222	1	1	B0	TS1
	NX100-S6L	55B24L	12	45	36	75	350	237	128	200	222	0	3	B0	TS1



SPECIFICATION

Group Number	JIS old Type	JIS new Type	Nominal Voltage (V)	C ₂₀ Capacity (Ah)	C ₅ Capacity (Ah)	RC (min)	CCA (SAE)	Maximum Overall dimension(mm)				Cell Layout	Terminal	Hold Down	Handles
								L	W	H	TH				
B24	NX100-S6	55B24R	12	45	36	75	350	237	128	200	222	1	3	B0	TS1
	NX100-S6L(S)	55B24LS	12	45	36	75	500	237	128	200	222	0	1	B0	TS1
	NX100-S6(S)	55B24RS	12	45	36	75	500	237	128	200	222	1	1	B0	TS1
D20	/	50D20L	12	50	40	79	450	200	171	198	219	0	1	B0	TS1
	/	50D20R	12	50	40	79	450	200	171	198	219	1	1	B0	TS1
D23	/	55D23L	12	60	48	98	550	230	170	199	219	0	1	B0	TS1
	/	55D23R	12	60	48	98	550	230	170	199	219	1	1	B0	TS1
	/	75D23L	12	65	52	105	600	230	170	199	219	0	1	B0	TS1
	/	75D23R	12	65	52	105	600	230	170	199	219	1	1	B0	TS1
D26	N50L	48D26L	12	50	40	79	430	269	173	203	224	0	1	B1	TS5
	N50	48D26R	12	50	40	79	430	269	173	203	224	1	1	B1	TS5
	N50ZL	55D26L	12	60	48	98	530	269	173	203	224	0	1	B1	TS5
	N50Z	55D26R	12	60	48	98	530	269	173	203	224	1	1	B1	TS5
	N570L	65D26L	12	65	52	108	570	269	173	203	224	0	1	B1	TS5
	N570	65D26R	12	65	52	108	570	269	173	203	224	1	1	B1	TS5
	N570L	75D26L	12	65	52	108	570	269	173	203	224	0	1	B1	TS5
	N570	75D26R	12	65	52	108	570	269	173	203	224	1	1	B1	TS5
	NX110-5L	80D26L	12	70	55	118	620	269	173	203	224	0	1	B1	TS5
NX110-5	80D26R	12	70	55	118	620	269	173	203	224	1	1	B1	TS5	
D31	N70L	65D31L	12	70	56	118	580	303	170	201	222	0	1	B1	TS1
	N70	65D31R	12	70	56	118	580	303	170	201	222	1	1	B1	TS1
	N70ZL	75D31L	12	75	60	128	620	303	170	201	222	0	1	B1	TS1
	N70Z	75D31R	12	75	60	128	620	303	170	201	222	1	1	B1	TS1
	NX120-7L	95D31L	12	90	64	138	660	303	170	201	222	0	1	B1	TS1
	NX120-7	95D31R	12	90	64	138	660	303	170	201	222	1	1	B1	TS1
	/	105D31L	12	85	64	145	700	303	170	201	222	0	1	B1	TS1
	/	105D31R	12	85	64	145	700	303	170	201	222	1	1	B1	TS1
E41	N100L	95E41L	12	100	80	179	750	409	170	209	233	0	1	B0	TS8
	N100	95E41R	12	100	80	179	750	409	170	209	233	1	1	B0	TS8
	N100ZL	105E41L	12	105	83	190	780	409	170	209	233	0	1	B0	TS8
	N100Z	105E41R	12	105	83	190	780	409	170	209	233	1	1	B0	TS8
	N100ZL	115E41L	12	110	88	201	820	409	170	209	233	0	1	B0	TS8
	N100Z	115E41R	12	110	88	201	820	409	170	209	233	1	1	B0	TS8
	NX200-10L	130E41L	12	120	92	215	850	409	170	209	233	0	1	B0	TS8
NX200-10	130E41R	12	120	92	215	850	409	170	209	233	1	1	B0	TS8	
F51	N120L	115F51	12	120	96	223	800	504	180	208	232	4	1	B0	TS8
	N120R	115F51R	12	120	96	223	800	504	180	208	232	3	1	B0	TS8
	NS150L	145F51	12	135	112	256	850	504	180	208	232	4	1	B0	TS8
	NS150R	145F51R	12	135	112	256	850	504	180	208	232	3	1	B0	TS8
G51	N150L	145G51	12	150	120	290	900	507	219	212	234	4	1	B0	TS8
	N150R	145G51R	12	150	120	290	900	507	219	212	234	3	1	B0	TS8
	NS200	165G51	12	165	136	324	1000	507	219	212	234	4	1	B0	TS8
	NS200R	165G51R	12	165	136	324	1000	507	219	212	234	3	1	B0	TS8
	N180	195G51	12	180	140	360	1050	507	219	212	234	4	1	B0	TS8
	N180R	195G51R	12	180	140	360	1050	507	219	212	234	3	1	B0	TS8
H52	N200L	190H52	12	200	160	407	1100	514	265	211	236	4	1	B0	TS8
	N200R	190H52R	12	200	160	407	1100	514	265	211	236	3	1	B0	TS8
	N220	245H52	12	220	176	456	1200	514	265	211	236	4	1	B0	TS8
	N220	245H52	12	220	176	456	1200	514	265	211	250	4	4	B0	TS8
	N220R	245H52R	12	220	176	456	1200	514	265	211	236	3	1	B0	TS8
	N220R	245H52R	12	220	176	456	1200	514	265	211	250	3	4	B0	TS8

DIN TYPE

(CALCIUM-CALCIUM)

MAINTENANCE FREE BATTERY



↓ SPECIFICATION

Group Number	Model	Nominal Voltage (V)	C ₂₀ Capacity (Ah)	RC (min)	CCA (SAE)	Maximum Overall dimension(mm)				Cell Layout	Terminal	Hold Down	Handles
						L	W	H	TH				
LB1	53628	12	36	54	350	206	174	173	173	1	1	B13	TS2
	53654	12	36	54	350	206	174	173	173	0	1	B13	TS2
	54316	12	43	66	430	206	174	173	173	0	1	B13	TS2
	54317	12	43	66	430	206	174	173	173	0	19	B13	TS2
	54465	12	44	68	430	206	174	173	173	0	1	B13	TS2
L1	54459	12	44	68	430	207	174	190	190	0	1	B13	TS2
	54464	12	44	68	430	207	174	190	190	1	1	B13	TS2
LB2	54519	12	45	70	450	242	174	174	174	0	1	B13	TS2
	55046	12	50	79	500	242	174	174	174	0	1	B13	TS2
	55218	12	55	88	550	242	174	174	174	0	1	B13	TS2
	55563	12	55	88	550	242	174	174	174	1	1	B13	TS2
	56077L	12	60	95	600	242	174	174	174	0	1	B13	TS2
	56077R	12	60	95	600	242	174	174	174	1	1	B13	TS2
L2	55427	12	54	87	510	242	174	174	174	0	19	B13	TS2
	55530/55559/55573	12	55	88	530	242	173	190	190	0	1	B13	TS2
	55565	12	55	88	530	242	173	190	190	1	1	B13	TS2
	56219	12	62	98	580	242	173	190	190	0	1	B13	TS2
	56221	12	62	98	580	242	173	190	190	1	1	B13	TS2



SPECIFICATION

Group Number	Model	Nominal Voltage (V)	C ₂₀ Capacity (Ah)	RC (min)	CCA (SAE)	Maximum Overall dimension(mm)				Cell Layout	Terminal	Hold Down	Handles
						L	W	H	TH				
LB3	56420	12	64	106	600	276	174	174	174	0	1	B13	TS2
	57113	12	68	115	630	276	174	174	174	0	1	B13	TS2
L3	56638	12	66	110	590	274	174	190	190	0	1	B13	TS3
	57219	12	72	122	650	274	174	190	190	1	1	B13	TS3
	57220	12	72	122	650	274	174	190	190	0	1	B13	TS3
	57412	12	75	125	680	274	174	190	190	0	1	B13	TS3
	57540	12	75	125	680	274	174	190	190	0	1	B13	TS3
L4	58043	12	80	138	680	313.5	174	189	189	0	1	B13	TS1
LB4	58211	12	78	135	670	310	174	173	173	0	1	B13	TS6
LB5	58515	12	85	148	710	351	175	173	173	0	1	B13	TS6
	58815	12	88	154	750	351	175	173	173	0	1	B13	TS6
L5	58821	12	88	154	730	351	174	188	188	1	1	B13	TS6
	58827	12	88	154	730	351	174	188	188	0	1	B13	TS6
	59218	12	88	154	730	351	174	188	188	0	1	B13	TS6
	59524	12	95	169	770	351	174	188	188	0	1	B13	TS6
	60044	12	100	175	810	351	174	188	188	0	1	B13	TS6
B20	53520	12	36	54	335	195	126	201	221	0	3	B0	TS1
	53521	12	36	54	335	195	126	201	221	0	1	B0	TS1
	53522	12	36	54	335	195	126	201	221	1	3	B0	TS1
	53534	12	36	54	335	195	126	201	221	1	1	B0	TS1
B24	54523	12	45	70	450	237	128	200	222	0	1	B0	TS1
	54524	12	45	70	450	237	128	200	222	1	1	B0	TS1
	54551	12	45	70	350	237	128	200	222	1	3	B0	TS1
	54584	12	45	70	350	237	128	200	222	0	3	B0	TS1
	54523	12	45	70	450	237	136	200	222	0	1	B1	TS1
	54524	12	45	70	450	237	136	200	222	1	1	B1	TS1
	54551	12	45	70	350	237	136	200	222	1	3	B1	TS1
	54584	12	45	70	350	237	136	200	222	0	3	B1	TS1
	54577	12	45	70	430	221	136	206	227	0	1	B1	/
	54579	12	45	70	430	221	136	206	227	1	1	B1	/
D20	55041	12	50	79	450	200	171	198	219	0	1	B0	TS1
	55042	12	50	79	450	200	171	198	219	1	1	B0	TS1
D23	56068	12	60	98	550	230	170	199	219	0	1	B0	TS1
	56069	12	60	98	550	230	170	199	219	1	1	B0	TS1
27	58513	12	83	145	700	303	170	201	222	0	1	B1	TS1
	58514	12	83	145	700	303	170	201	222	1	1	B1	TS1
E41	60026	12	100	179	750	409	170	209	233	0	1	B0	TS8
	60525	12	105	190	780	409	170	209	233	0	1	B0	TS8
D33	/	12	95	169	760	326	170	206	228	1	1	B0	TS1
D4	61017	12	110	201	700	504	180	208	232	3	1	B0	TS8
	62034	12	120	223	800	504	180	208	232	3	1	B0	TS8
	63530	12	135	256	850	504	180	208	232	3	1	B0	TS8
D5	64317	12	150	290	900	507	219	212	234	3	1	B0	TS8
	64323	12	143	274	850	507	219	212	234	3	1	B0	TS8
	65012	12	150	290	900	507	219	212	234	4	1	B0	TS8
	66514	12	165	324	1000	507	219	212	234	3	1	B0	TS8
	68025	12	180	360	1050	507	219	212	234	3	1	B0	TS8
D6	70027	12	200	407	1100	514	265	211	236	3	1	B0	TS8
	71014	12	210	432	1150	514	265	211	236	3	1	B0	TS8
	72018	12	220	456	1200	514	265	211	236	3	1	B0	TS8

BIC TYPE

(CALCIUM-CALCIUM)

MAINTENANCE FREE BATTERY



REASONABLE PRICE RELIABLE QUALITY
TIMELY DELIVERY FRIENDLY SERVICE



SPECIFICATION

Group Number	Model	Nominal Voltage (V)	C ₂₀ Capacity (Ah)	RC (min)	CCA(SAE)		Maximum Overall dimension(mm)				Cell Layout	Terminal	Hold Down	Handles
					0°F (-18°C)	32°F (0°C)	L	W	H	TH				
U1	U1-L	12	16	12	144	172	196	132	160	186	1	4	B0	/
	U1L-H	12	20	18	200	240	196	132	160	186	1	4	B0	/
	U1L-250	12	24	25	250	300	196	132	160	186	1	4	B0	/
	U1L-265	12	28	35	265	315	196	132	160	186	1	4	B0	/
	U1L-370	12	32	42	310	372	196	132	160	186	1	4	B0	/
U1R	U1-R	12	16	12	144	172	196	132	160	186	0	4	B0	/
	U1R	12	20	18	200	240	196	132	160	186	0	4	B0	/
	U1R-250	12	24	25	250	300	196	132	160	186	0	4	B0	/
	U1R-265	12	28	35	265	315	196	132	160	186	0	4	B0	/
	U1R-370	12	32	42	310	372	196	132	160	186	0	4	B0	/
24	24-430	12	50	79	430	516	259	173	203	223	1	1	B1	TS1
	24-480	12	55	88	480	576	259	173	203	223	1	1	B1	TS1
	24-530	12	60	98	530	636	259	173	203	223	1	1	B1	TS1
	24-570	12	65	108	570	684	259	173	203	223	1	1	B1	TS1
	24-620	12	70	118	620	744	259	173	203	223	1	1	B1	TS1
24R	24R-430	12	50	79	430	516	259	173	203	223	0	1	B1	TS1
	24R-480	12	55	88	480	576	259	173	203	223	0	1	B1	TS1
	24R-530	12	60	98	530	636	259	173	203	223	0	1	B1	TS1
	24R-570	12	65	108	570	684	259	173	203	223	0	1	B1	TS1
	24R-620	12	70	118	620	744	259	173	203	223	0	1	B1	TS1



SPECIFICATION

Group Number	Model	Nominal Voltage (V)	C ₂₀ Capacity (Ah)	RC (min)	CCA(SAE)		Maximum Overall dimension(mm)				Cell Layout	Terminal	Hold Down	Handles
					0°F (-18°C)	32°F (0°C)	L	W	H	TH				
24F	24R-430	12	50	79	430	516	265	175	200	221	0	1	B9	TS1
	24R-480	12	55	88	480	576	265	175	200	221	0	1	B9	TS1
	24R-530	12	60	98	530	636	265	175	200	221	0	1	B9	TS1
	24R-570	12	65	108	570	684	265	175	200	221	0	1	B9	TS1
	24R-620	12	70	118	620	744	265	175	200	221	0	1	B9	TS1
25	25-500	12	55	88	500	600	225	173	200	221	1	1	B1	TS1
	25-550	12	60	98	550	660	225	173	200	221	1	1	B1	TS1
	25-600	12	(63)	105	600	720	225	173	200	221	1	1	B1	TS1
27	27-530	12	65	108	530	636	303	170	201	222	1	1	B1	TS1
	27-580	12	70	118	580	696	303	170	201	222	1	1	B1	TS1
	27-620	12	75	128	620	744	303	170	201	222	1	1	B1	TS1
27R	27R-530	12	65	108	530	636	303	170	201	222	0	1	B1	TS1
	27R-580	12	70	118	580	696	303	170	201	222	0	1	B1	TS1
	27R-620	12	75	128	620	744	303	170	201	222	0	1	B1	TS1
31A	31A-600	12	75	128	600	720	332	171	219	240	1	5	B0	TS5
	31A-650	12	80	138	650	780	332	171	219	240	1	5	B0	TS5
	31A-700	12	90	158	700	840	332	171	219	240	1	5	B0	TS5
	31A-750	12	95	169	750	900	332	171	219	240	1	5	B0	TS5
	31A-800	12	100	179	800	960	332	171	219	240	1	5	B0	TS5
31P(S)	31P(s)-600	12	75	128	600	720	332	171	219	252	1	11	B0	TS5
	31P(s)-650	12	80	138	650	780	332	171	219	252	1	11	B0	TS5
	31P(s)-700	12	90	158	700	840	332	171	219	252	1	11	B0	TS5
	31P(s)-750	12	95	169	750	900	332	171	219	252	1	11	B0	TS5
	31P(s)-800	12	100	179	800	960	332	171	219	252	1	11	B0	TS5
31T	31T-600	12	75	128	600	720	332	171	219	243	1	13	B0	TS5
	31T-650	12	80	138	650	780	332	171	219	243	1	13	B0	TS5
	31T-700	12	90	158	700	840	332	171	219	243	1	13	B0	TS5
	31T-750	12	95	169	750	900	332	171	219	243	1	13	B0	TS5
	31T-800	12	100	179	800	960	332	171	219	243	1	13	B0	TS5
34	34-550	12	60	98	550	660	268	172	182	202	1	1	B1	TS5
	34-650	12	68	115	650	780	268	172	182	202	1	1	B1	TS5
	34-700	12	71	120	700	840	268	172	182	202	1	1	B1	TS5
34R	34R-550	12	60	98	550	660	268	172	182	202	0	1	B1	TS5
	34R-650	12	68	115	650	780	268	172	182	202	0	1	B1	TS5
	34R-700	12	71	120	700	840	268	172	182	202	0	1	B1	TS5
35	35-500	12	55	88	500	600	236	171	201	221	0	1	B1	TS5
	35-550	12	60	98	550	660	236	171	201	221	0	1	B1	TS5
	35-600	12	65	108	600	720	236	171	201	221	0	1	B1	TS5
48	48-650	12	72	122	650	780	274	174	190	190	0	1	B13	TS3
	48-680	12	75	125	680	816	274	174	190	190	0	1	B13	TS3
49	49-730	12	88	154	730	876	351	173	190	190	0	1	B13	TS6
	49-810	12	100	175	810	972	351	173	190	190	0	1	B13	TS6
51	51-450	12	45	70	450	540	237	136	200	222	1	1	B1	TS1
51R	51R-450	12	45	70	450	540	237	136	200	222	0	1	B1	TS1
58	58-500	12	48	75	500	600	240	174	157	177	1	1	B1	TS5
	58-550	12	55	88	550	660	240	174	157	177	1	1	B1	TS5
58R	58R-500	12	48	75	500	600	240	174	157	177	0	1	B1	TS5
	58R-550	12	55	88	550	660	240	174	157	177	0	1	B1	TS5
65	65-630	12	75	128	630	756	301	190	170	190	1	1	B1	TS4
75	75-450	12	45	70	450	540	238	180	182	182	6	20	B1	TS5
	75-550	12	55	88	550	660	238	180	182	182	6	20	B1	TS5



SPECIFICATION

Group Number	Model	Nominal Voltage (V)	C ₂₀ Capacity (Ah)	RC (min)	CCA(SAE)		Maximum Overall dimension(mm)				Cell Layout	Terminal	Hold Down	Handles
					0°F (-18°C)	32°F (0°C)	L	W	H	TH				
75/86	75/86-550	12	55	88	550	660	238	180	182	203	6	1/20	B1	TS5
78	78-550	12	60	98	550	660	268	180	182	182	6	20	B1	TS5
	78-675	12	65	108	675	810	268	180	182	182	6	20	B1	TS5
78/34	78/34-600	12	65	108	600	720	268	180	182	203	6	1/20	B1	TS5
85	85-500	12	55	88	500	600	238	172	185	206	0	1	B1	TS5
	85-550	12	60	98	550	660	238	172	185	206	0	1	B1	TS5
	85-610	12	63	105	610	732	238	172	185	206	0	1	B1	TS5
86	86-500	12	55	88	500	600	238	172	185	206	1	1	B1	TS5
	86-550	12	60	98	550	660	238	172	185	206	1	1	B1	TS5
	86-610	12	63	105	610	732	238	172	185	206	1	1	B1	TS5
91	91-550	12	60	98	550	660	276	174	174	174	0	1	B13	TS2
92	92-650	12	80	132	650	780	310	174	173	173	0	1	B13	TS6
93	93-780	12	88	154	750	900	351	175	173	173	0	1	B13	TS6
90	90-550	12	55	88	550	660	242	174	174	174	0	1	B13	TS2
4D	4D-2	12	135	256	850	1020	507	219	212	234	4	1	B0	TS8
	4D-3	12	165	324	1000	1200	507	219	212	234	4	1	B0	TS8
8D	8D-3	12	200	407	1100	1200	514	265	211	236	4	1	B0	TS8
	8D-4	12	220	456	1200	1200	514	265	211	236	4	1	B0	TS8



Automatic expanded plates production line

JIS TYPE CHARGED BATTERY

CONVENTIONAL



SPECIFICATION

Group Number	JIS old Type	JIS new Type	Nominal Voltage (V)	C ₂₀ Capacity (Ah)	RC (min)	CCA (SAE)	Maximum Overall dimension (mm)				Cell Layout	Terminal	Hold Down	Handles	Dry Weight (Approx) (Kg)
							L	W	H	TH					
B20	NS40ZL	36B20L	12	36	55	280	198	127	204	224	0	3	B0	TS7	7.0
	NS40Z	36B20R	12	36	55	280	198	127	204	224	1	3	B0	TS7	7.0
B24	NS60L	55B24L	12	45	71	325	237	132	200	221	0	3	B0	TS7	8.3
	NS60	55B25R	12	45	71	325	237	132	200	221	1	3	B0	TS7	8.3
	NS60L	55B24LS	12	45	71	325	237	132	200	221	0	1	B0	TS7	8.3
	NS60	55B25RS	12	45	71	325	237	132	200	221	1	1	B0	TS7	8.3
D26	N50ZL	55D26L	12	60	100	450	260	169	205	227	0	1	B0	TS7	11.0
	N50Z	55D26R	12	60	100	450	260	169	205	227	1	1	B0	TS7	11.0
D31	N70L	65D31L	12	70	120	500	309	171	203	225	0	1	B0	TS7	13.1
	N70	65D31R	12	70	120	500	309	171	203	225	1	1	B0	TS7	13.1
	N70ZL	95D31L	12	80	140	550	309	171	203	225	0	1	B0	TS7	14.7
	N70Z	95D31R	12	80	140	550	309	171	203	225	1	1	B0	TS7	14.7
E41	N100L	95E41L	12	100	182	620	405	172	207	229	0	1	B0	TS8	17.8
	N100	95E41R	12	100	182	620	405	172	207	229	1	1	B0	TS8	17.8
	NS120L	115E41L	12	105	192	650	405	172	207	229	0	1	B0	TS8	18.5
	NS120	115E41R	12	105	192	650	405	172	207	229	1	1	B0	TS8	18.5
F51	N120L	135F51L	12	120	224	700	505	180	209	230	4	1	B0	TS8	21.6
	N120	135F51R	12	120	224	700	505	180	209	230	3	1	B0	TS8	21.6
G51	N150L	160G51L	12	150	292	800	505	220	211	232	4	1	B0	TS8	26.0
	N150R	160G51R	12	150	292	800	505	220	211	232	3	1	B0	TS8	26.0
H52	N200L	210H52L	12	200	409	1000	506	264	214	236	4	1	B0	TS8	33.7
	N200	210H52R	12	200	409	1000	506	264	214	236	3	1	B0	TS8	33.7



PRODUCT STRUCTURE

High Performance Maintenance Free Series Battery

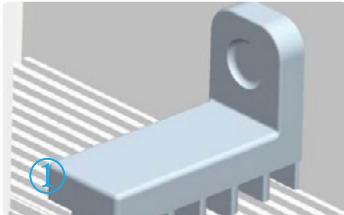

Strap and Lead part for welding

Parts are cast and weld with high conductivity lead alloy, using TTP welding technology, excellent performance on high rate startup.

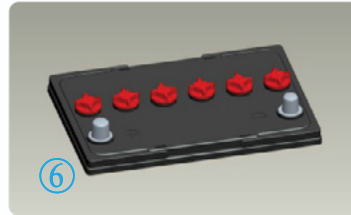

Battery lid

Polypropylene injection molding, heat sealing technology, outfit with special water injection plug reduce water volatilization.



Laminated Glass Separator

Using imported Laminated Glass separator, excellent performance on high rate discharging, efficiently prevent active material peel off from plate

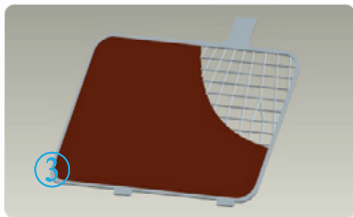

Plate

Using high purity lead antimony alloy plate, minimized water volatilization. Dry charged plate technique, good startup performance, Startup up vehicle 10minute after filling acid.

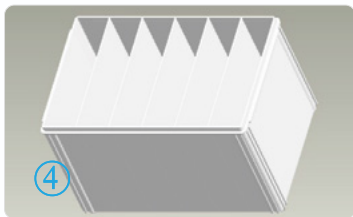

Cell slot

Polypropylene injection molding, high intensity, smooth and clear surface. Anti shock and vibration structure design.



Terminal

Made by high intensity lead alloy, anti mechanical damage, good conductivity, suitable for high rate discharging



Injection Line

Automatic injection machines to ensure good battery case



TYPICAL APPLICATIONS

- ❖ Applicable for automotive, tractor, startup of mining and construction vehicle, lighting and ignition.
- ❖ Applicable for startup and ignition of all gasoline and diesel engine.
- ❖ Applicable for power supply of the electric equipment on automotive, tractor, mining and construction vehicle.

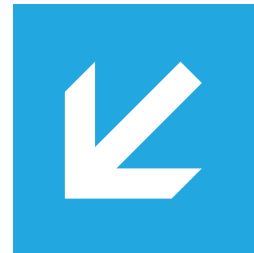



USER GUIDE

※ For our battery end user

- ◆ Please choose correct model for your vehicle.
- ◆ Check the charge indicator is in green before you buy
- ◆ Confirm your car engine charging system with an output voltage between 13.8V to 14.4V
- ◆ If the total power of equipment is higher than the battery design work load, please change to a higher capacity model.

※ Please noted during charging

- ◆ Constant voltage charging: please charge with 16V (maximum 16.2V) keep good ventilation. Reduce charging voltage if battery temperature rise over 45°C or charging current over 25A.
- ◆ Constant current charging: please charge with current 0.1C₂₀ A, and can not over this limit. Please stop charging if indicator turn green or open circuit over 12.65V

※ Something you should know

- ◆ Do not connect and avoid accidentally connection between positive and negative pole with metallic conductor to avoid short circuit.
- ◆ Avoid convert connection or unstable connection.
- ◆ Do not fill in unqualified electrolyte or water.
- ◆ Do not operate under insufficient electrolyte condition. Semi maintenance free battery should be filled in pure water regularly.
- ◆ Do not use in deep cycle (capacity lower than 50%, electrolyte gravity below 1.200g/ml).
- ◆ Keep safe vent-valve work properly to avoid explosion caused by valve failure.
- ◆ Do not invert or incline more than 45 ° during transfer or storing.
- ◆ Keep ventilation on during charging, no smoking.
- ◆ Wear goggle when remove or check the battery.



Automatic plates grouping production line